

TUJ 512

Dimensions

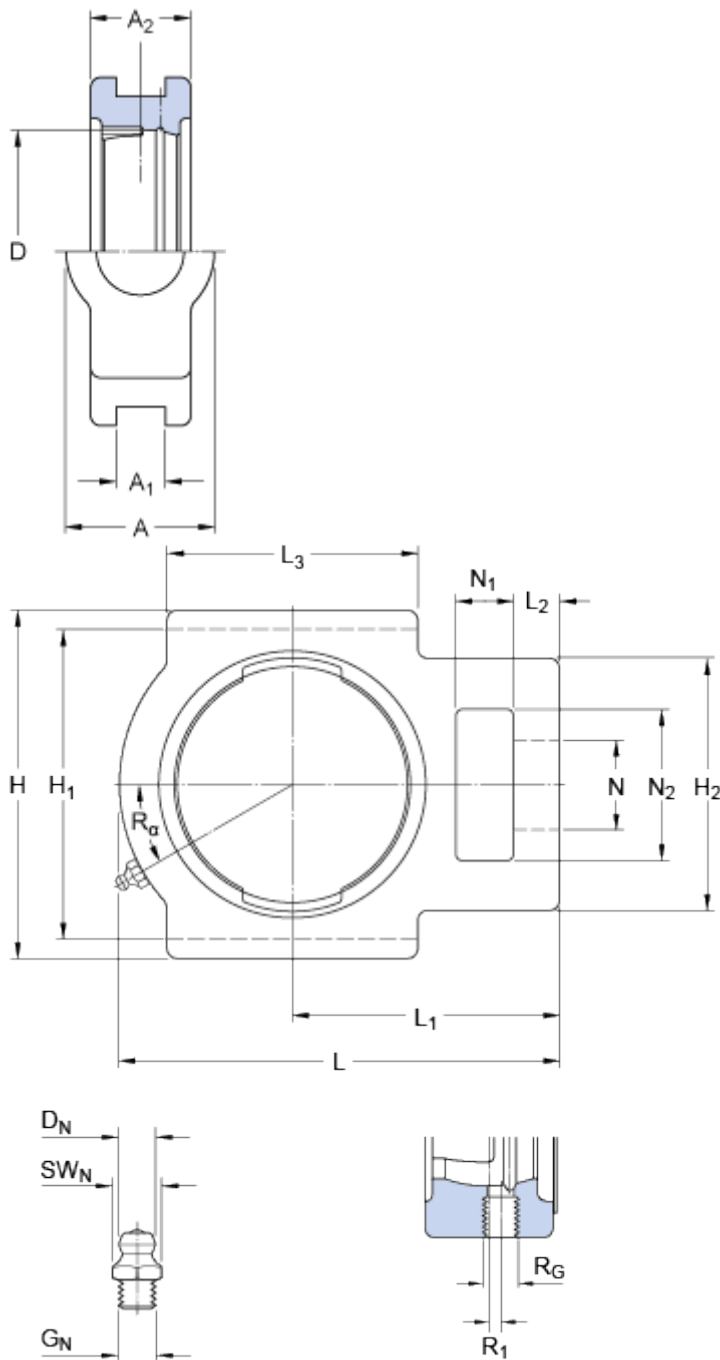

D	110	mm
A	60	mm
A ₁	22	mm
A ₂	44	mm
H	146	mm
H ₁	130	mm
H ₂	102	mm
L	186	mm
L ₁	118	mm
L ₂	19	mm
L ₃	100	mm
N	35	mm
N ₁	32	mm
N ₂	63.5	mm

Threaded hole

R _G	1/4-28 UNF	
R ₁	5.5	mm
R _α	30	°

Grease fitting

D _N	6.5	mm
SW _N	7	mm
G _N	1/4-28 SAE-LT	

Mass

Mass housing

3.1

kg