

PHF TB3030X75MM

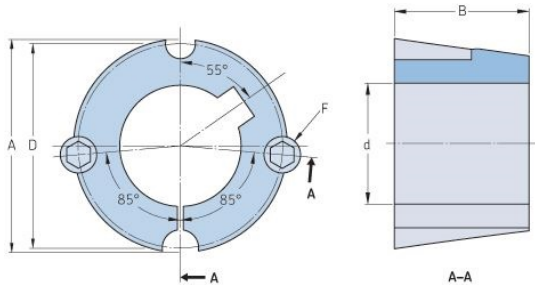

Bushing no.	TB3030
d = Bore diameter (mm)	75
Bore diameter (in)	2.95
Keyway width (mm)	20
Keyway width (in)	0.79
Keyway depth (mm)	4.9
Keyway depth (in)	0.19
A (mm)	108
A (in)	4.25
B (mm)	76.2
B (in)	3
D (mm)	101.6
D (in)	4
E (mm)	-
E (in)	-
F (mm)	15.875 x 31.750
F (in)	-
Weight (kg)	1.89
Weight (lbs)	4.17