

# PHF TB3020X65MM

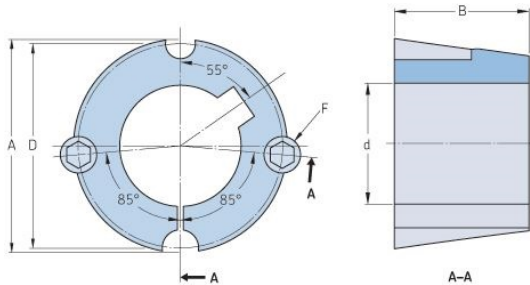

Bushing no.	<b>TB3020</b>
d = Bore diameter (mm)	<b>65</b>
Bore diameter (in)	<b>2.56</b>
Keyway width (mm)	<b>18</b>
Keyway width (in)	<b>0.71</b>
Keyway depth (mm)	<b>4.4</b>
Keyway depth (in)	<b>0.17</b>
A (mm)	<b>108</b>
A (in)	<b>4.25</b>
B (mm)	<b>50.8</b>
B (in)	<b>2</b>
D (mm)	<b>101.6</b>
D (in)	<b>4</b>
E (mm)	-
E (in)	-
F (mm)	<b>15.875 x 31.750</b>
F (in)	-
Weight (kg)	<b>1.73</b>
Weight (lbs)	<b>3.81</b>