

PHF TB1615X1.125

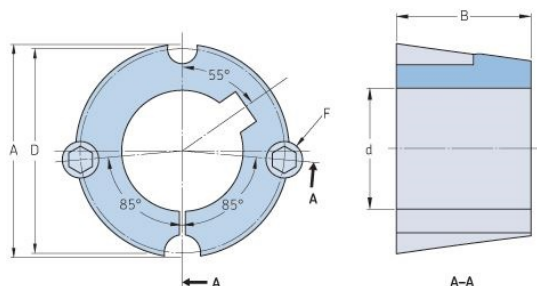

Bushing no.	TB1615
d = Bore diameter (mm)	29
Bore diameter (in)	1.14
Keyway width (mm)	7.9
Keyway width (in)	0.31
Keyway depth (mm)	3.2
Keyway depth (in)	0.13
A (mm)	57.2
A (in)	2.25
B (mm)	38.1
B (in)	1.5
D (mm)	54
D (in)	2.13
E (mm)	-
E (in)	-
F (mm)	9.525 x 15.875
F (in)	-
Weight (kg)	0.43
Weight (lbs)	0.95