

PHF TB1215X18MM

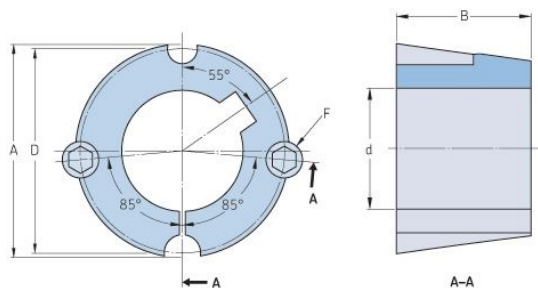

Bushing no.	TB1215
d = Bore diameter (mm)	18
Bore diameter (in)	0.71
Keyway width (mm)	6
Keyway width (in)	0.24
Keyway depth (mm)	2.8
Keyway depth (in)	0.11
A (mm)	47.6
A (in)	1.87
B (mm)	38.1
B (in)	1.5
D (mm)	44.5
D (in)	1.75
E (mm)	-
E (in)	-
F (mm)	9.525 x 15.875
F (in)	-
Weight (kg)	0.33
Weight (lbs)	0.73