

PHF TB1108X12MM

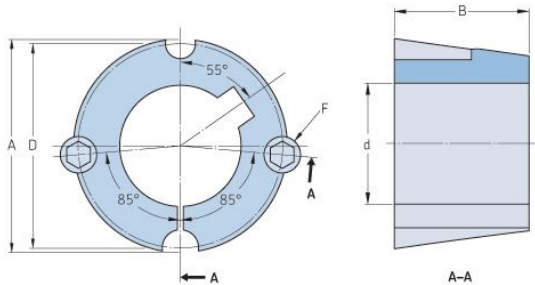

| | |
|------------------------|-----------------------|
| Bushing no. | TB1108 |
| d = Bore diameter (mm) | 12 |
| Bore diameter (in) | 0.47 |
| Keyway width (mm) | 4 |
| Keyway width (in) | 0.16 |
| Keyway depth (mm) | 1.8 |
| Keyway depth (in) | 0.07 |
| A (mm) | 38.4 |
| A (in) | 1.51 |
| B (mm) | 22.2 |
| B (in) | 0.87 |
| D (mm) | 36.9 |
| D (in) | 1.45 |
| E (mm) | - |
| E (in) | - |
| F (mm) | 6.350 x 12.700 |
| F (in) | - |
| Weight (kg) | 0.14 |
| Weight (lbs) | 0.31 |