

PF 47

Dimensions

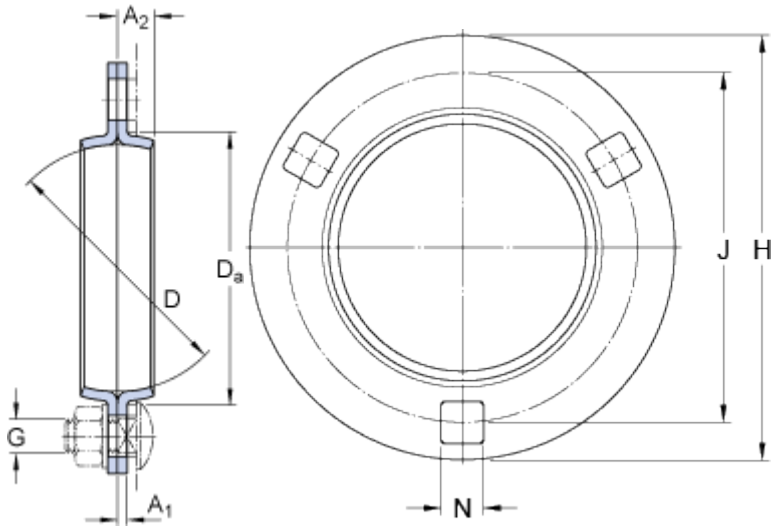

D		47	mm
D _a	min.	51	mm
A ₁		2	mm
A ₂		8	mm
J		71.4	mm
H		90	mm
N		8.7	mm

Calculation data

Permissible radial load	max.	3.3	kN
-------------------------	------	-----	----

Mass

Mass housing	0.16	kg
--------------	------	----

Mounting information

Recommended diameter for attachment bolts, mm	G	8	mm
Recommended diameter for attachment bolts, inch	G	0.3125	in