

PCMW 203601.5 E

Dimensions

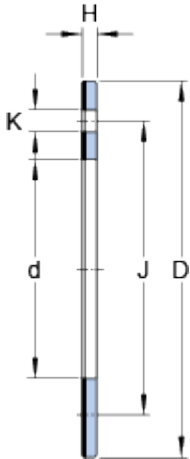

| | | |
|-----|------|----|
| d | 20 | mm |
| D | 36 | mm |
| H | 1.5 | mm |
| J | 28 | mm |
| K | 3.25 | mm |

Abutment dimensions

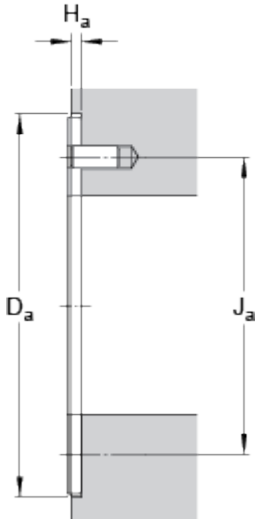

| | | |
|-------|----|----|
| D_a | 36 | mm |
| J_a | 28 | mm |
| H_a | 1 | mm |

Calculation data

| | | | |
|---|------------|------|-------------------|
| Basic dynamic load rating - radial direction | C | 56 | kN |
| Basic static load rating - radial direction | C | 176 | kN |
| Specific dynamic load factor | K | 80 | N/mm ² |
| Specific static load factor | K | 250 | N/mm ² |
| Factor depending on material and bearing type | K_M | 300 | |
| Permissible sliding velocity | v max. | 2 | m/s |
| Permissible sliding velocity | v min. | 0 | m/s |
| Coefficient of friction | μ max. | 0.25 | |
| Coefficient of friction | μ min. | 0.03 | |

Mass

| | | |
|--------------------|--------|----|
| Mass thrust washer | 0.0078 | kg |
|--------------------|--------|----|

