

FY 510 M

Material

Cast iron

Dimensions

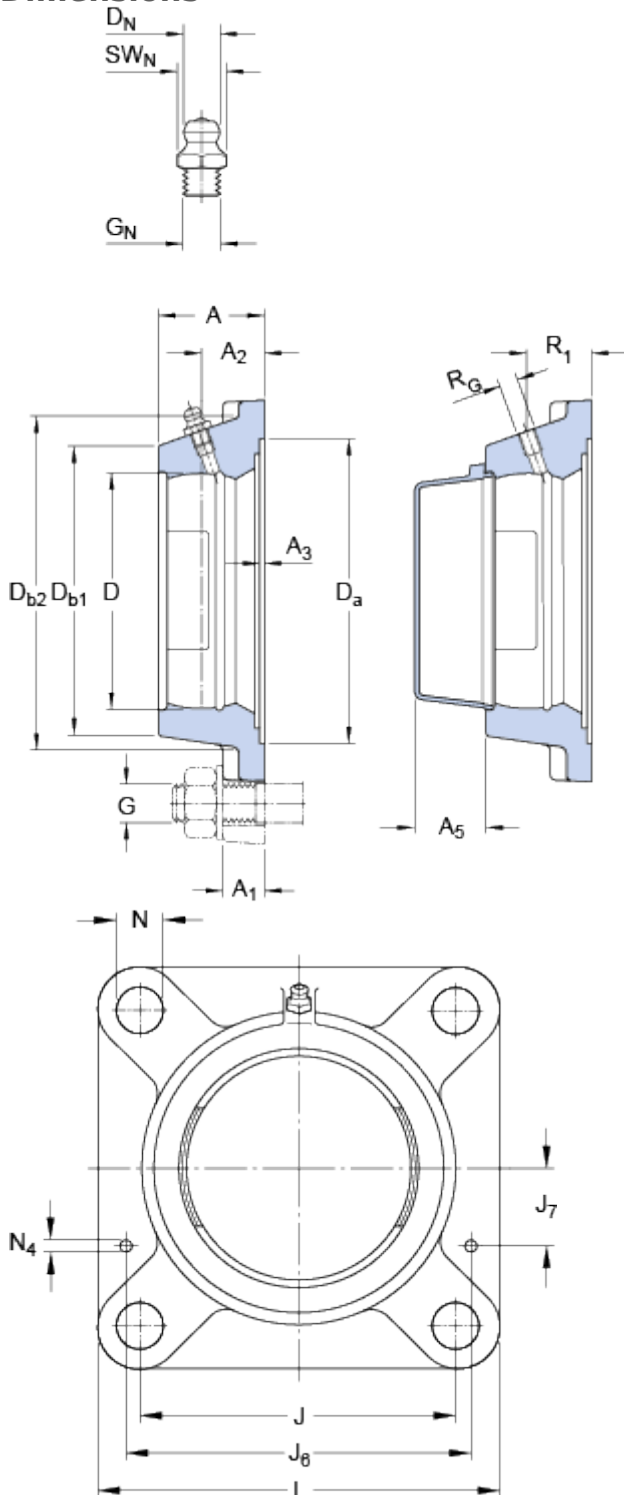

D		90	mm
D _a	H11	125.4	mm
D _{b1}		107	mm
D _{b2}		118	mm
A		43	mm
A ₁		15	mm
A ₂		28	mm
A ₃	H14	3.2	mm
A ₅		29.5	mm
J		111	mm
L		143	mm
N		18	mm

Threaded hole

R_G 1/4-28 UNF

R₁ 28.5 mm

Grease fitting

D_N 6.5 mm

SW_N 7 mm

G_N 1/4-28 SAE-LT

Dowel pins

J₆ 129 mm

J₇ 35.5 mm

N₄ 4 mm

Mass

Mass housing

1.5

kg

Mounting information

Recommended diameter for attachment bolts, mm

G

16

mm

Recommended diameter for attachment bolts, inch

G

0.625

in

Appropriate products

End cover

ECY 210

