

# FYTJ 25 TF

Housing material

Cast iron

## Dimensions

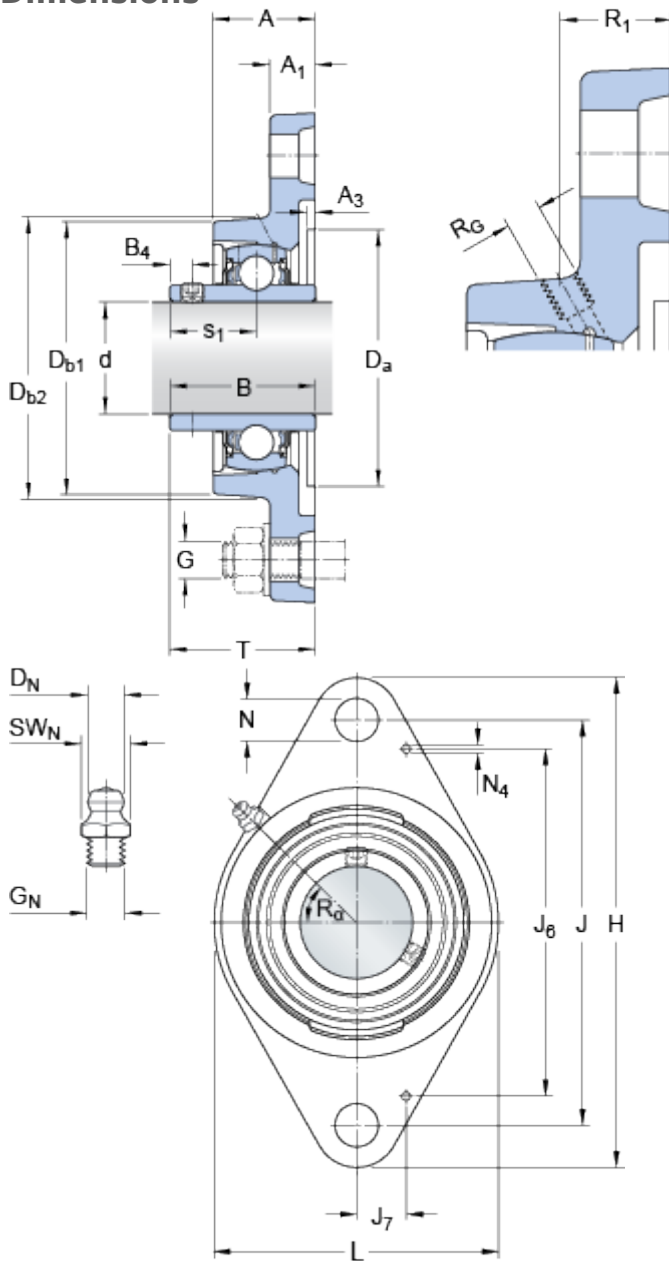

d		25	mm
D <sub>a</sub>	H11	63.5	mm
D <sub>b1</sub>		65	mm
D <sub>b2</sub>		68	mm
A		27	mm
A <sub>1</sub>		14	mm
A <sub>3</sub>	H14	3.2	mm
B		34.1	mm
B <sub>4</sub>		5	mm
J		99	mm
H		130	mm
L		68	mm
N		16	mm
s <sub>1</sub>		19.8	mm
T		35.8	mm

### Threaded hole

R <sub>G</sub>		1/4-28 UNF	
R <sub>1</sub>		18	mm
R <sub>α</sub>		45	°

### Grease fitting

D <sub>N</sub>		6.5	mm
SW <sub>N</sub>		7	mm
G <sub>N</sub>		1/4-28 SAE-LT	

### Dowel pins

J <sub>6</sub>		81	mm
J <sub>7</sub>		12	mm
N <sub>4</sub>		2	mm

## Calculation data

Basic dynamic load rating	C	14	kN
Basic static load rating	C	7.8	kN
Fatigue load limit	P <sub>u</sub>	0.335	kN
Limiting speed		7000	r/min

(with shaft tolerance h6)

## Mass

---

Mass bearing unit	0.59	kg
-------------------	------	----

## Mounting information

---

Thread grub screw	G <sub>2</sub>	M6x0.75	
Hexagonal key size for grub screw	N	3	mm
Recommended tightening torque for grub screw		4	N·m
Recommended diameter for attachment bolts, mm	G	14	mm
Recommended diameter for attachment bolts, inch	G	0.5625	in

## Included products

---

Housing	<a href="#">FYTJ 505</a>
Bearing	<a href="#">YAR 205-2F</a>