

# FYC 55 TF

Housing material

Cast iron

## Dimensions

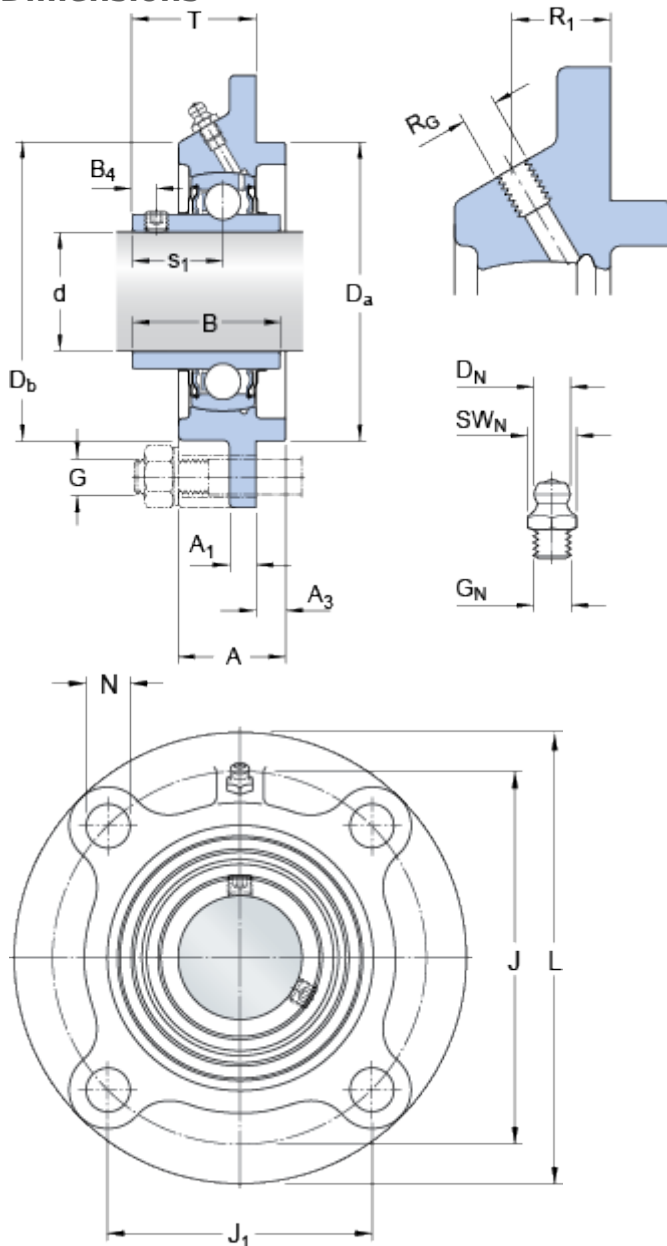

d	55	mm
A	43	mm
A <sub>1</sub>	15	mm
A <sub>3</sub>	12	mm
B	55.6	mm
B <sub>4</sub>	9	mm
D <sub>a</sub>	h8 125	mm
D <sub>b</sub>	127.1	mm
J	150	mm
J <sub>1</sub>	106.1	mm
L	185	mm
N	19	mm
s <sub>1</sub>	33.4	mm
T	46.4	mm

## Threaded hole

R<sub>G</sub> 1/4-28 UNF

R<sub>1</sub> 24.5 mm

## Grease fitting

D<sub>N</sub> 6.5 mm

SW<sub>N</sub> 7 mm

G<sub>N</sub> 1/4-28 SAE-LT

## Calculation data

Basic dynamic load rating	C	43.6	kN
Basic static load rating	C	29	kN
Fatigue load limit	P <sub>u</sub>	1.25	kN
Limiting speed with shaft tolerance h6		3600	r/min

## Mass

Mass unit 3.95 kg

## Mounting information

Thread grub screw	G <sub>2</sub>	M10x1
Hexagonal key size for grub screw	N	5 mm
Recommended tightening torque for grub screw		16.5 N·m

Recommended diameter for attachment bolts, mm	G	16	mm
Recommended diameter for attachment bolts, inch	G	0.625	in

### **Appertaining products**

---

Bearing	YAR 211-2F
Housing	FYC 511