

FYC 512

Dimensions

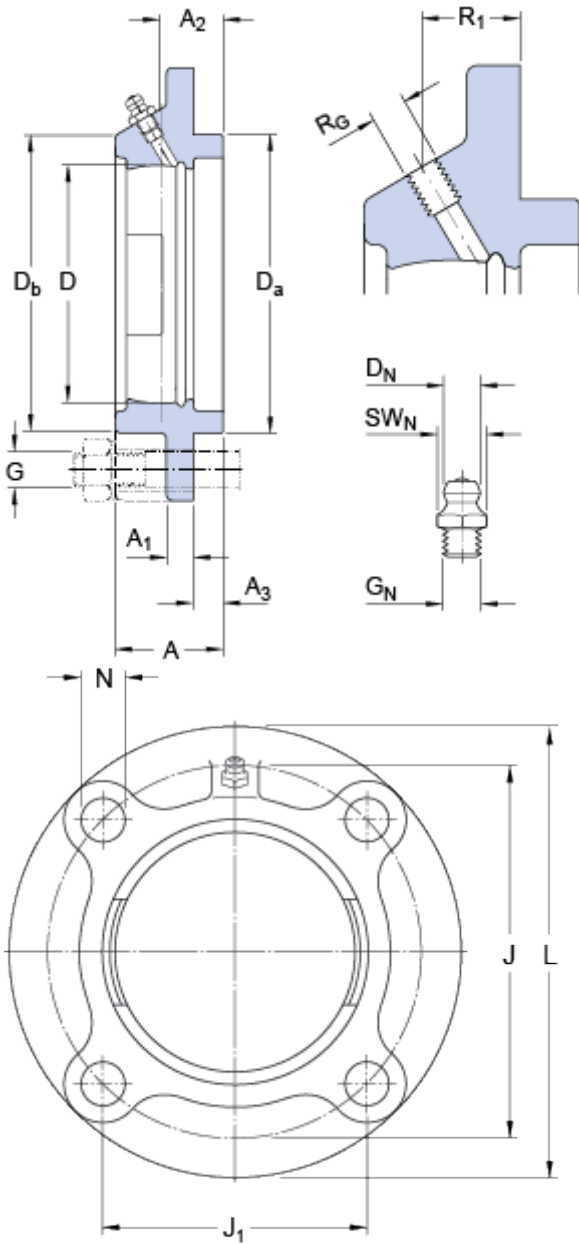

D	110	mm
D_a	h8 135	mm
D_b	137.1	mm
A	48	mm
A_1	15	mm
A_2	29	mm
A_3	12	mm
J	160	mm
J_1	113.1	mm
L	195	mm
N	19	mm

Threaded hole

R_G	1/4-28 UNF
R_1	24.5 mm

Grease fitting

D_N	6.5 mm
SW_N	7 mm
G_N	1/4-28 SAE-LT

Mass

Mass housing	3.45	kg
--------------	------	----

Mounting information

Recommended diameter for attachment bolts, mm	G	16	mm
Recommended diameter for attachment bolts, inch	G	0.625	in