

FYC 509

Dimensions

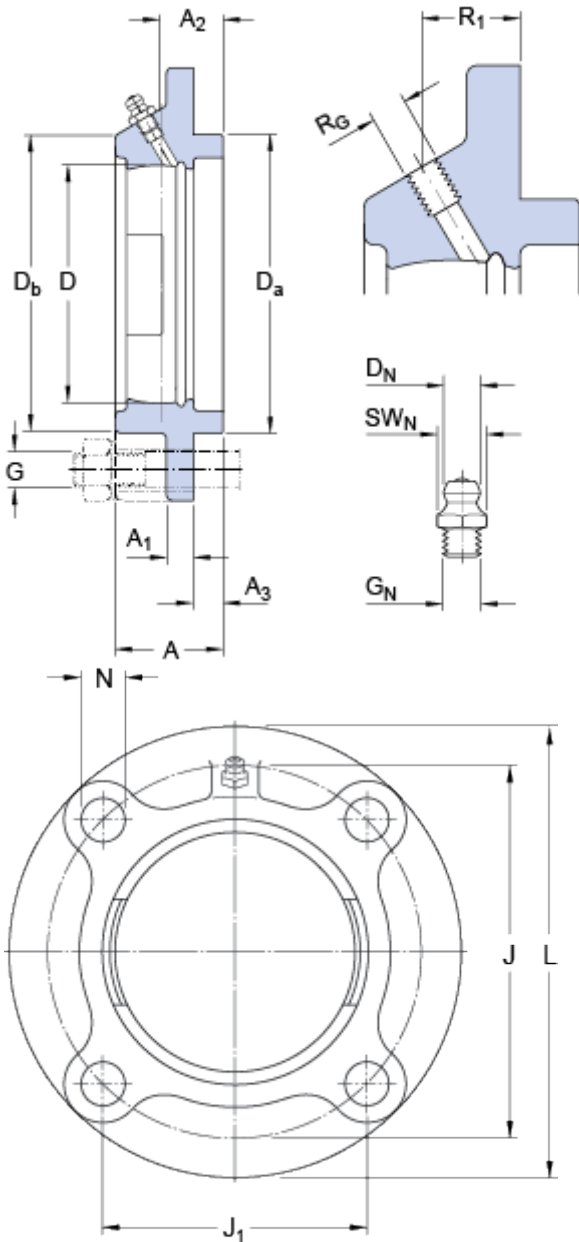

D	85	mm
D_a	h8 105	mm
D_b	106.1	mm
A	37.5	mm
A_1	14	mm
A_2	22	mm
A_3	12	mm
J	132	mm
J_1	93.3	mm
L	160	mm
N	16	mm

Threaded hole

R_G	1/4-28 UNF
R_1	21 mm

Grease fitting

D_N	6.5 mm
SW_N	7 mm
G_N	1/4-28 SAE-LT

Mass

Mass housing	1.95	kg
--------------	------	----

Mounting information

Recommended diameter for attachment bolts, mm	G	14	mm
Recommended diameter for attachment bolts, inch	G	0.5625	in