

BK 1210

Dimensions

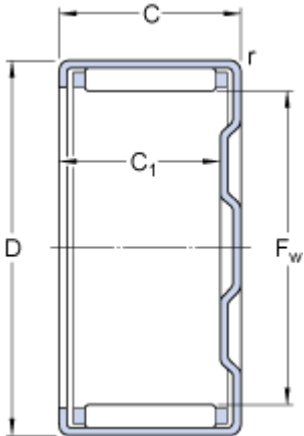

| | | |
|----------------|----------|----|
| F _w | 12 | mm |
| D | 16 | mm |
| C | 10 | mm |
| C ₁ | min. 8.4 | mm |
| r | min. 0.4 | mm |

Calculation data

| | | | |
|---------------------------|----------------|-------|-------|
| Basic dynamic load rating | C | 4.84 | kN |
| Basic static load rating | C | 6.4 | kN |
| Fatigue load limit | P _u | 0.71 | kN |
| Reference speed | | 16000 | r/min |
| Limiting speed | | 18000 | r/min |

Mass

| | | |
|--------------|---------|----|
| Mass bearing | 0.0052 | kg |
| Designation | BK 1210 | |

Associated products

| | |
|---|---------------------------|
| Inner ring IR series | IR 8x12x10.5 |
| Inner ring LR series | LR 8x12x10.5 |
| Radial shaft seal with a low cross-sectional height, single lip | G 12x16x3 |