

AH 2313 G

Dimensions

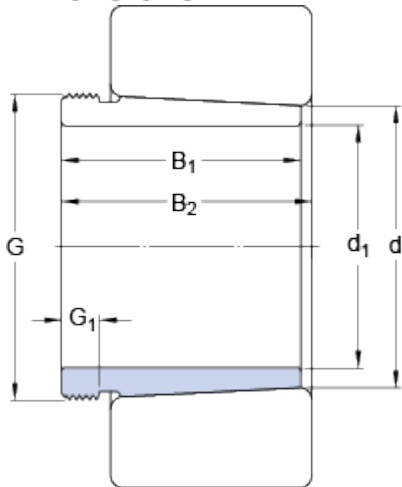

d_1	60	mm
d	65	mm
B_1	61	mm
B_2	64	mm
G	M 70x2	
G_1	12	mm

Mass

Mass withdrawal sleeve	0.36	kg
------------------------	------	----

Associated products

Hydraulic nut	HMV 14 E
Nut for removal	KM 14