

# AHX 3228 G

## Dimensions

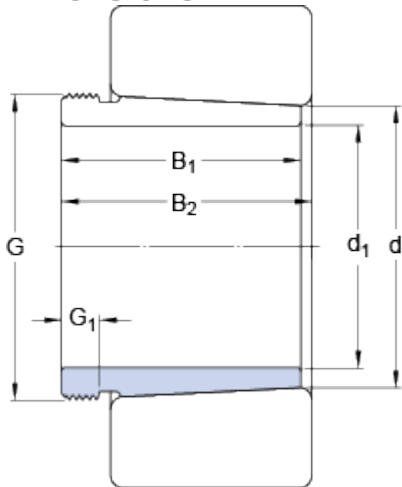

$d_1$	135	mm
$d$	140	mm
$B_1$	104	mm
$B_2$	109	mm
$G$	M 150x2	
$G_1$	15	mm

## Mass

Mass withdrawal sleeve	1.75	kg
------------------------	------	----

## Associated products

Hydraulic nut	HMV 30 E
Nut for removal	<a href="#">KM 30</a>