

AHX 3128

Dimensions

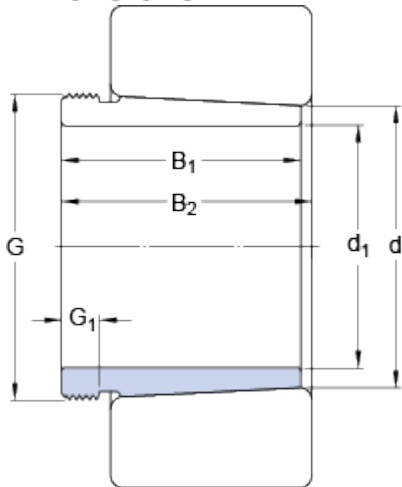

d_1	135	mm
d	140	mm
B_1	83	mm
B_2	88	mm
G	M 150x2	
G_1	14	mm

Mass

Mass withdrawal sleeve	1.3	kg
------------------------	-----	----

Associated products

Hydraulic nut	HMV 30 E
Nut for removal	KM 30