

# AHX 3124

## Dimensions

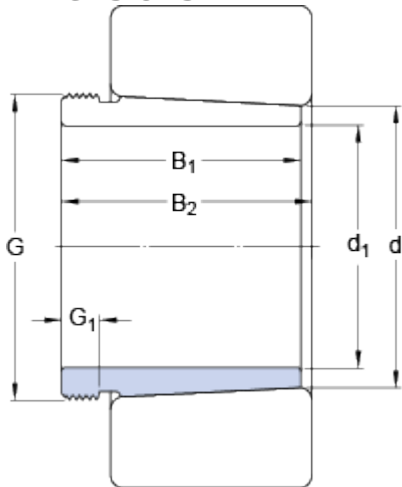

$d_1$	115	mm
$d$	120	mm
$B_1$	75	mm
$B_2$	79	mm
$G$	M 130x2	
$G_1$	12	mm

## Mass

Mass withdrawal sleeve	0.94	kg
------------------------	------	----

## Associated products

Hydraulic nut	HMV 26 E
Nut for removal	<a href="#">KM 26</a>