

# AHX 2315 G

## Dimensions

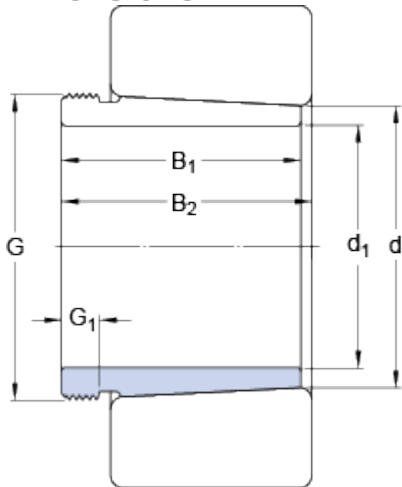

$d_1$	70	mm
$d$	75	mm
$B_1$	68	mm
$B_2$	72	mm
$G$	M 80x2	
$G_1$	12	mm

## Mass

Mass withdrawal sleeve	0.48	kg
------------------------	------	----

## Associated products

Hydraulic nut	HMV 16 E
Nut for removal	<a href="#">KM 16</a>