

AHX 2312

Dimensions

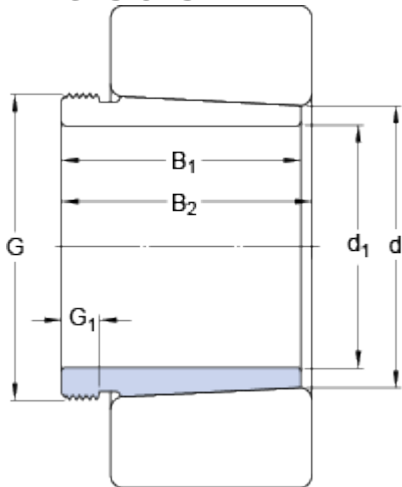

d_1	55	mm
d	60	mm
B_1	58	mm
B_2	61	mm
G	M 65x2	
G_1	11	mm

Mass

Mass withdrawal sleeve	0.3	kg
------------------------	-----	----

Associated products

Hydraulic nut	HMV 13 E
Nut for removal	KM 13