

1726209-2RS1

Dimensions

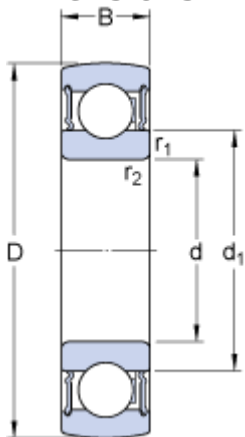

d		45	mm
D		85	mm
B		19	mm
d ₁	≈	56.6	mm
r _{1,2}	min.	1	mm

Calculation data

Basic dynamic load rating	C	33.2	kN
Basic static load rating	C	21.6	kN
Fatigue load limit	P _u	0.915	kN
Limiting speed ¹⁾		5000	r/min
Calculation factor	f	14	

Mass

Mass complete bearing		0.4	kg
-----------------------	--	-----	----