

# 1726208-2RS1

## Dimensions

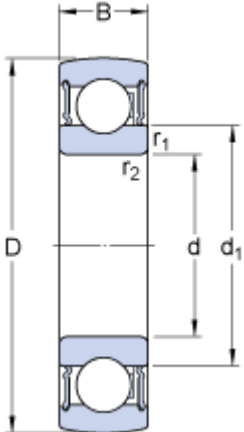

d	40	mm
D	80	mm
B	18	mm
d <sub>1</sub>	≈ 52.6	mm
r <sub>1,2</sub>	min. 1.1	mm

## Calculation data

Basic dynamic load rating	C	30.7	kN
Basic static load rating	C	19	kN
Fatigue load limit	P <sub>u</sub>	0.8	kN
Limiting speed <sup>1)</sup>		5600	r/min
Calculation factor	f	14	

## Mass

Mass complete bearing		0.35	kg
-----------------------	--	------	----

## Associated products

Rubber seating ring		<a href="#">RIS 208 A</a>	
---------------------	--	---------------------------	--