

1726203-2RS1

Dimensions

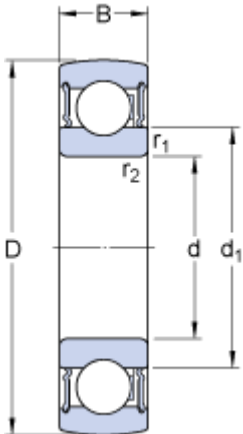

d	17	mm
D	40	mm
B	12	mm
d ₁	≈ 24.5	mm
r _{1,2}	min. 0.6	mm

Calculation data

Basic dynamic load rating	C	9.56	kN
Basic static load rating	C	4.75	kN
Fatigue load limit	P _u	0.2	kN
Limiting speed ¹⁾		12000	r/min
Calculation factor	f	13	

Mass

Mass complete bearing		0.06	kg
-----------------------	--	------	----

Associated products

Rubber seating ring		RIS 203	
---------------------	--	-------------------------	--