

YSP 208 SB-2F

Dimensions

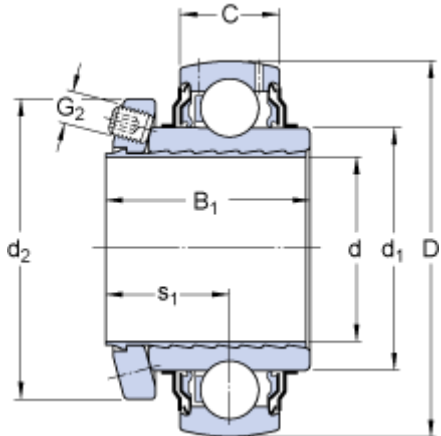

d	40	mm
D	80	mm
B ₁	43.1	mm
C	21	mm
d ₁	≈ 51.8	mm
d ₂	62	mm
s ₁	26.2	mm

Values specified for B₁ and s₁ are approximate and before the grub screw is tightened (sleeve and inner ring bore at starting position).

Calculation data

Basic dynamic load rating	C	30.7	kN
Basic static load rating	C	19	kN
Fatigue load limit	P _u	0.8	kN
Limiting speed ¹⁾		4800	r/min
Calculation factor	f	14	

Mass

Mass complete bearing	0.59	kg
-----------------------	------	----

Mounting information

Thread grub screw	G ₂	M6	
Hexagonal key size for grub screw	N	3.05	mm
Recommended tightening torque for grub screw		7.4	N·m

Associated products

Rubber seating ring	RIS 208 A
---------------------	---------------------------