

W 608-2Z

Dimensions

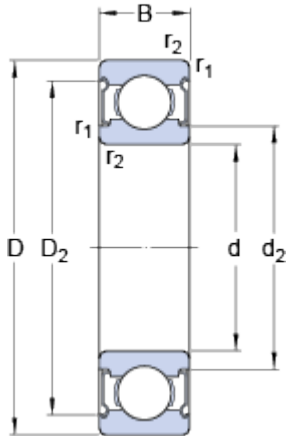

d		8	mm
D		22	mm
B		7	mm
d ₂	≈	10.5	mm
D ₂	≈	19.03	mm
r _{1,2}	min.	0.3	mm

Abutment dimensions

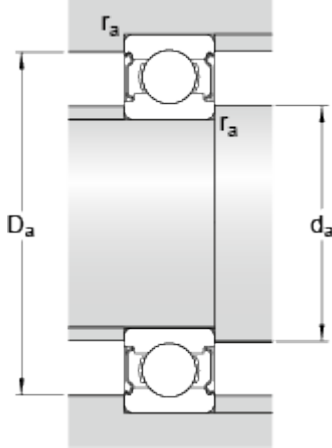

d _a	min.	10	mm
d _a	max.	10.4	mm
D _a	max.	20	mm
r _a	max.	0.3	mm

Calculation data

Basic dynamic load rating	C	1.99	kN
Basic static load rating	C	0.78	kN
Fatigue load limit	P _u	0.034	kN
Reference speed		75000	r/min
Limiting speed		38000	r/min
Calculation factor	k _r	0.03	
Calculation factor	f	7.2	

Mass

Mass bearing		0.012	kg
--------------	--	-------	----