

# TU 40 TF

Housing material

Cast iron

## Dimensions

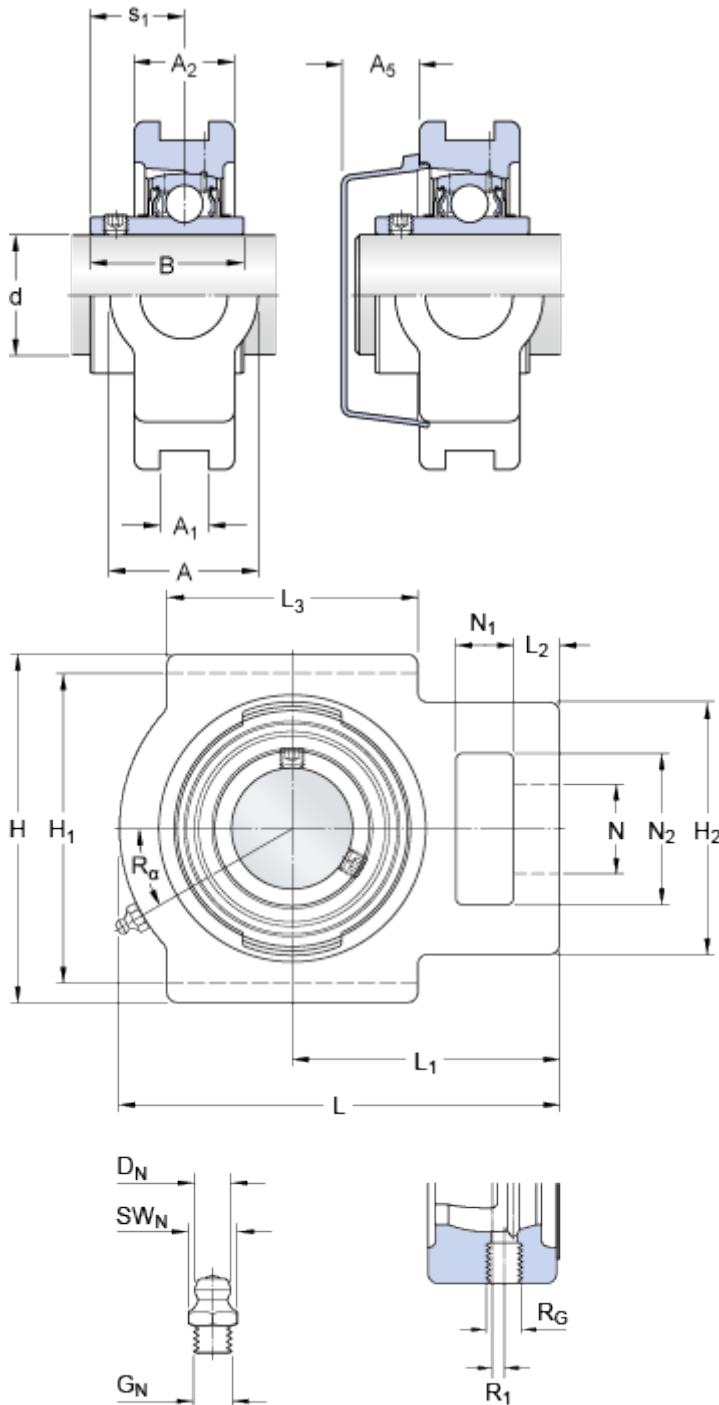

$d$	40	mm
$A$	49	mm
$A_1$	17.5	mm
$A_2$	33	mm
$A_5$	23.5	mm
$B$	49.2	mm
$B_4$	8	mm
$H$	115	mm
$H_1$	101	mm
$H_2$	83	mm
$L$	145	mm
$L_1$	88	mm
$L_2$	15	mm
$L_3$	83	mm
$N$	29	mm
$N_1$	19	mm
$N_2$	50	mm
$s_1$	30.2	mm

## Threaded hole

$R_G$  1/4-28 UNF

$R_1$  4 mm

$R_\alpha$  30 °

## Grease fitting

$D_N$  6.5 mm

$SW_N$  7 mm

$G_N$  1/4-28 SAE-LT

## Calculation data

Basic dynamic load rating	C	30.7	kN
Basic static load rating	C	19	kN
Fatigue load limit	$P_u$	0.8	kN
Limiting speed with shaft tolerance h6		4800	r/min

## Mass

---

Mass bearing unit	2.25	kg
-------------------	------	----

---

### Mounting information

Grub (set) screw	G <sub>2</sub>	M8x1
Hexagonal key size for grub screw	N	4 mm
Recommended tightening torque for grub screw	6.5	N·m

---

### Included products

Housing	<a href="#">TU 508 M</a>
Bearing	<a href="#">YAR 208-2F</a>

---

### Associated products

End cover	<a href="#">ECY 208</a>
-----------	-------------------------