

TU 30 TF

Housing material

Cast iron

Dimensions

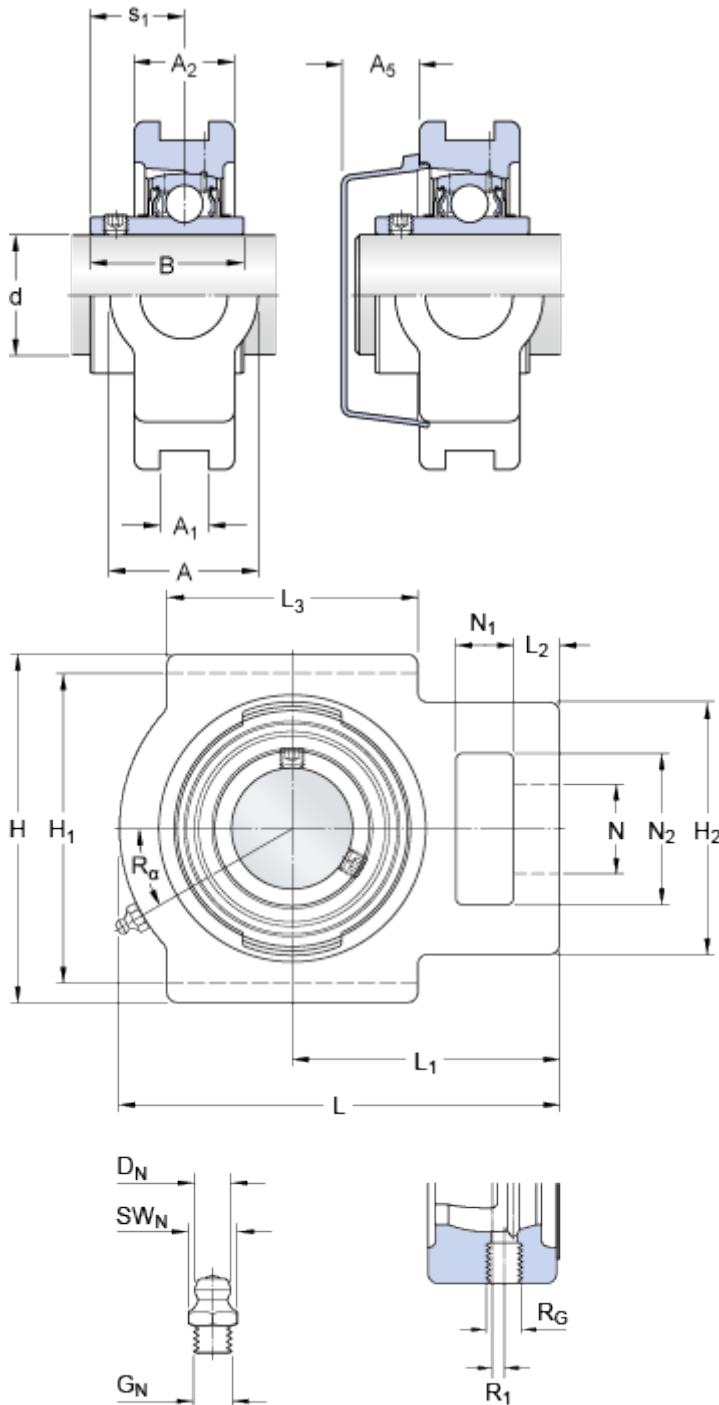

d	30	mm
A	37	mm
A_1	13.5	mm
A_2	28	mm
A_5	20	mm
B	38.1	mm
B_4	5	mm
H	104	mm
H_1	89	mm
H_2	56	mm
L	114	mm
L_1	70	mm
L_2	10	mm
L_3	57	mm
N	22	mm
N_1	16	mm
N_2	37	mm
s_1	22.2	mm

Threaded hole

R_G 1/4-28 UNF

R_1 3.5 mm

R_α 30 °

Grease fitting

D_N 6.5 mm

SW_N 7 mm

G_N 1/4-28 SAE-LT

Calculation data

Basic dynamic load rating	C	19.5	kN
Basic static load rating	C	11.2	kN
Fatigue load limit	P_u	0.475	kN
Limiting speed with shaft tolerance h6		6300	r/min

Mass

Mass bearing unit	1.2	kg
-------------------	-----	----

Mounting information

Grub (set) screw	G ₂	M6x0.75
Hexagonal key size for grub screw	N	3 mm
Recommended tightening torque for grub screw	4	N·m

Included products

Housing	TU 506 M
Bearing	YAR 206-2F

Associated products

End cover	ECY 206
-----------	-------------------------