

# SY 510 M

Material

Cast iron

## Dimensions

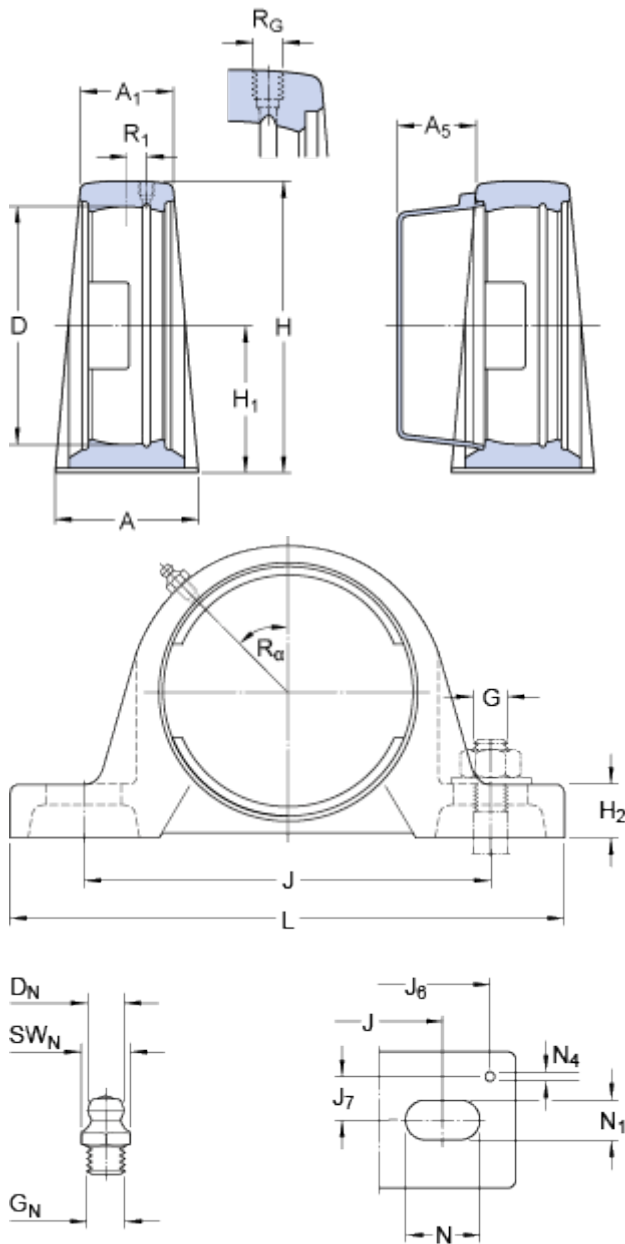

D	90	mm
H <sub>1</sub>	57.2	mm
A	54	mm
A <sub>1</sub>	34	mm
A <sub>5</sub>	29.5	mm
H	114	mm
H <sub>2</sub>	22	mm
J	157	mm
J	max. 165	mm
J	min. 149	mm
L	203	mm
N	26	mm
N <sub>1</sub>	18	mm

### Threaded hole

R <sub>G</sub>	1/4-28 UNF
R <sub>1</sub>	4 mm
R <sub>α</sub>	45 °

### Grease fitting

D <sub>N</sub>	6.5	mm
SW <sub>N</sub>	7	mm
G <sub>N</sub>	1/4-28 SAE-LT	

### Dowel pins

J <sub>6</sub>	187	mm
J <sub>7</sub>	19	mm
N <sub>4</sub>	4	mm

## Mass

Mass housing

1.9

kg

## Mounting information

Recommended diameter for attachment bolts, mm

G

16

mm

Recommended diameter for attachment bolts, inch

G

0.625

in

## Appropriate products

Appropriate end cover

[ECY 210](#)

