

# SYJ 90 TF

Material

Cast iron

## Dimensions

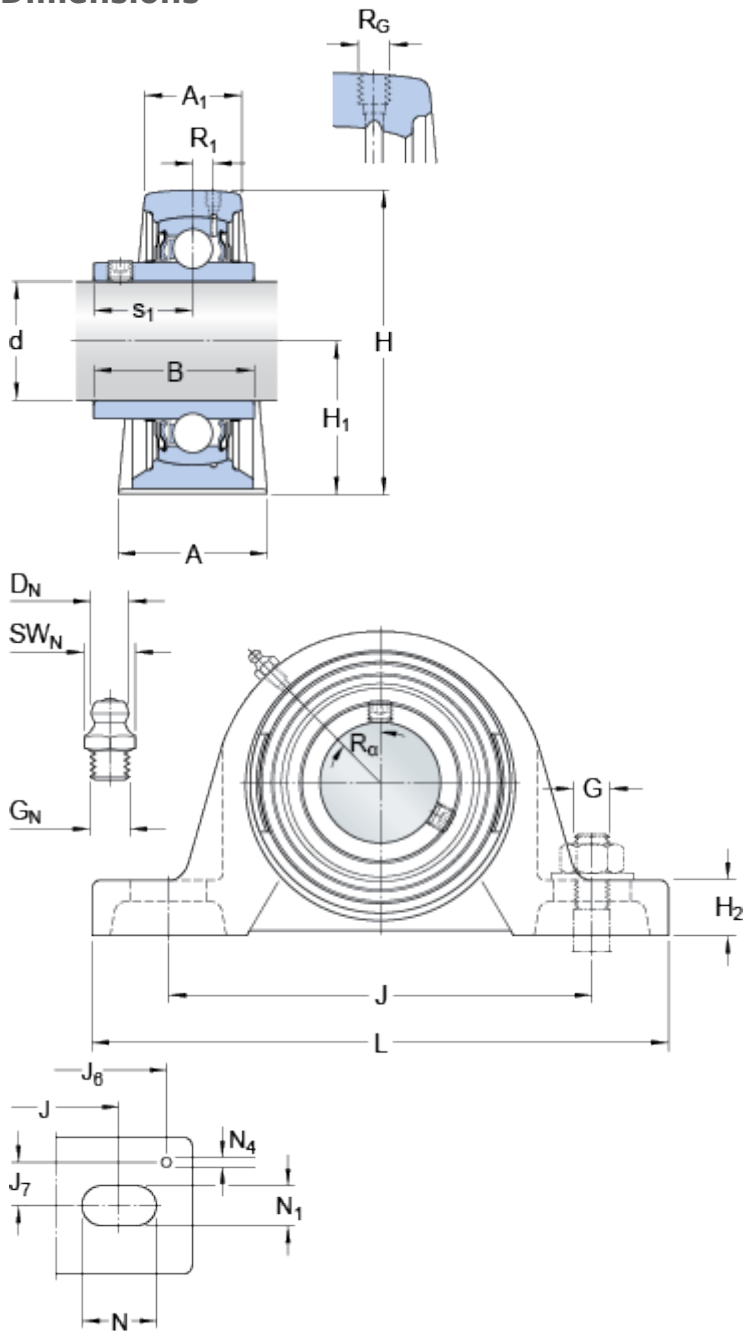

$d$	90	mm
$A$	88	mm
$A_1$	54	mm
$B$	89	mm
$H$	200.5	mm
$H_1$	101.6	mm
$H_2$	33	mm
$J$	262	mm
$J$	max. 270	mm
$J$	min. 254	mm
$L$	327	mm
$N$	35	mm
$N_1$	27	mm
$s_1$	54	mm

### Threaded hole

$R_G$	1/4-28 UNF
$R_1$	8.5 mm
$R_\alpha$	45 °

### Grease fitting

$D_N$	6.5 mm
$SW_N$	7 mm
$G_N$	1/4-28 SAE-LT

### Dowel pins

$J_6$	303 mm
$J_7$	32 mm
$N_4$	4 mm

## Calculation data

Basic dynamic load rating	C	95.6	kN
Basic static load rating	C	72	kN
Fatigue load limit	$P_u$	2.7	kN
Limiting speed		2000	r/min

(with shaft tolerance h6)

## Mass

---

Mass bearing unit	12.7	kg
-------------------	------	----

## Mounting information

---

Hexagonal key size for grub screw	N	6	mm
Recommended tightening torque for grub screw		28.5	N·m
Recommended diameter for attachment bolts, mm	G	22	mm
Recommended diameter for attachment bolts, inch	G	0.875	in

## Included products

---

Housing	<a href="#">SYJ 518</a>
Bearing	<a href="#">YAR 218-2F</a>