

SC 50 ES

Dimensions

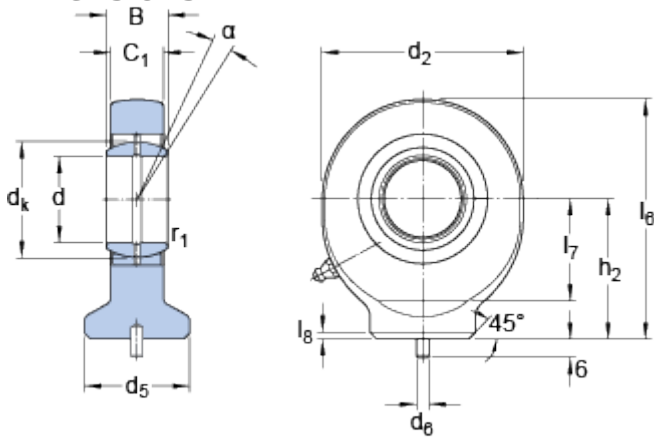

d		50	mm
d ₂	max.	114	mm
B		35	mm
C ₁	max.	31	mm
h ₂	js13	88	mm
α		6	°
d _k		66	mm
d ₅	max.	64	mm
d ₆		6	mm
l ₆	max.	150	mm
l ₇	min.	58	mm
l ₈		4	mm
r ₁	min.	0.6	mm

Calculation data

Basic dynamic load rating	C	156	kN
Basic static load rating	C	220	kN
Specific dynamic load factor	K	100	N/mm ²
Material constant	K _M	330	

Mass

Mass rod end		2.5	kg
--------------	--	-----	----