

QJ 310 MA

SKF Explorer

Dimensions

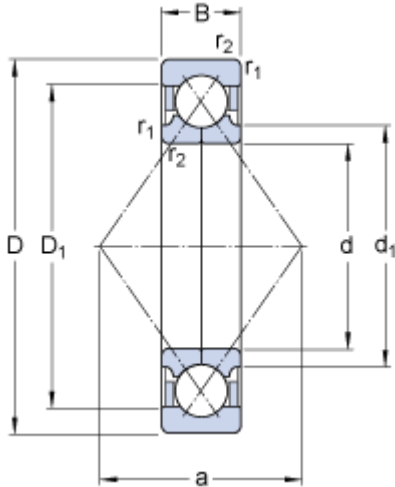

d	50	mm
D	110	mm
B	27	mm
d ₁	≈ 65	mm
D ₁	≈ 90	mm
a	56	mm
r _{1,2}	min. 2	mm

Abutment dimensions

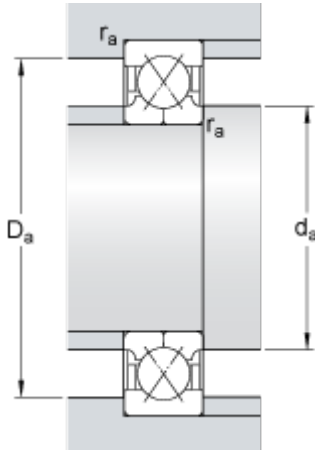

d _a	min.	61	mm
D _a	max.	99	mm
r _a	max.	2	mm

Calculation data

Basic dynamic load rating	C	118	kN
Basic static load rating	C	100	kN
Fatigue load limit	P _u	4.25	kN
Limiting speed		11000	r/min
Calculation factor	A	0.029	
Calculation factor	e	0.95	
Calculation factor	X	0.6	
Calculation factor	Y	0.58	
Calculation factor	Y ₁	0.66	
Calculation factor	Y ₂	1.07	

Mass

Mass bearing	1.35	kg
--------------	------	----

