

PRMF 606560

Dimensions

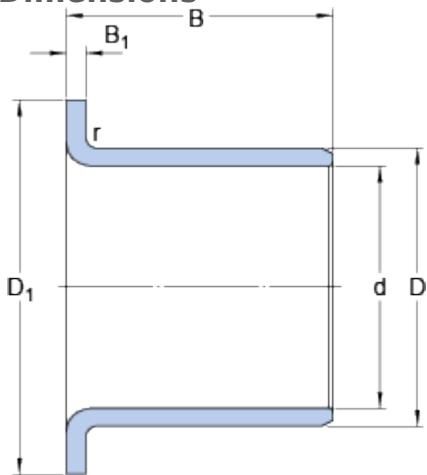

d	60	mm
D	65	mm
B	60	mm
D_1	75	mm
B_1	2.5	mm
r	max. 2.5	mm

Recommended fits

Tolerance shaft	f7 m/s
Tolerance housing	H7 m/s

Calculation data

Specific dynamic load factor	K	40	N/mm^2
Specific static load factor	K	120	N/mm^2
Permissible sliding velocity	v min.	0	m/s
Permissible sliding velocity	v max.	1	m/s
Coefficient of friction	μ min.	0.08	
Coefficient of friction	μ max.	0.15	

Mass

Mass bushing	0.26	kg
--------------	------	----