

# PHF TB2012X1.75

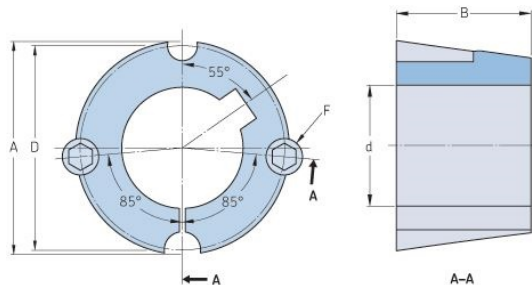

Bushing no.	<b>TB2012</b>
d = Bore diameter (mm)	<b>44</b>
Bore diameter (in)	<b>1.73</b>
Keyway width (mm)	<b>11.1</b>
Keyway width (in)	<b>0.44</b>
Keyway depth (mm)	<b>4</b>
Keyway depth (in)	<b>0.16</b>
A (mm)	<b>69.9</b>
A (in)	<b>2.75</b>
B (mm)	<b>31.8</b>
B (in)	<b>1.25</b>
D (mm)	<b>66.7</b>
D (in)	<b>2.63</b>
E (mm)	-
E (in)	-
F (mm)	<b>11.113 x 22.225</b>
F (in)	-
Weight (kg)	<b>0.45</b>
Weight (lbs)	<b>0.99</b>