

PHF TB1215X0.625

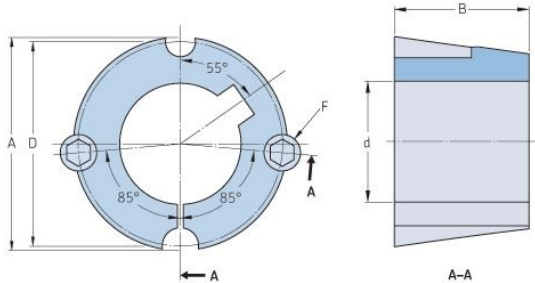

Bushing no.	TB1215
d = Bore diameter (mm)	16
Bore diameter (in)	0.63
Keyway width (mm)	4.8
Keyway width (in)	0.19
Keyway depth (mm)	2.4
Keyway depth (in)	0.09
A (mm)	47.6
A (in)	1.87
B (mm)	38.1
B (in)	1.5
D (mm)	44.5
D (in)	1.75
E (mm)	-
E (in)	-
F (mm)	9.525 x 15.875
F (in)	-
Weight (kg)	0.35
Weight (lbs)	0.77