

# PHF TB1210X0.75

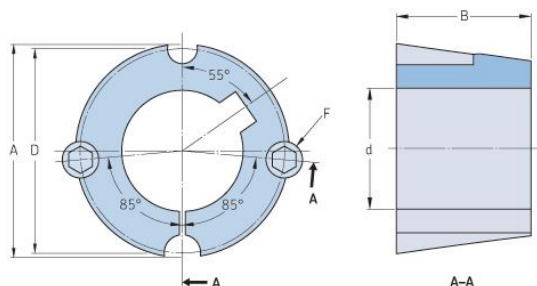

Bushing no.	<b>TB1210</b>
d = Bore diameter (mm)	<b>19</b>
Bore diameter (in)	<b>0.75</b>
Keyway width (mm)	<b>4.8</b>
Keyway width (in)	<b>0.19</b>
Keyway depth (mm)	<b>2.4</b>
Keyway depth (in)	<b>0.09</b>
A (mm)	<b>47.6</b>
A (in)	<b>1.87</b>
B (mm)	<b>25.4</b>
B (in)	<b>1</b>
D (mm)	<b>44.5</b>
D (in)	<b>1.75</b>
E (mm)	-
E (in)	-
F (mm)	<b>9.525 x 15.875</b>
F (in)	-
Weight (kg)	<b>0.22</b>
Weight (lbs)	<b>0.49</b>