

# PHF TB1108X1.125

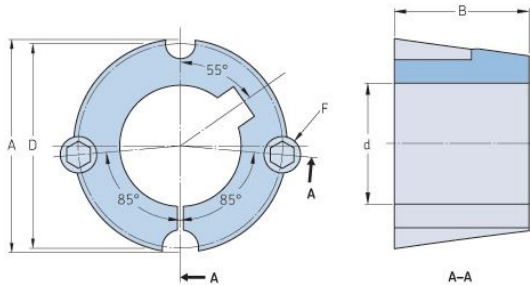

Bushing no.	<b>TB1108</b>
d = Bore diameter (mm)	<b>29</b>
Bore diameter (in)	<b>1.14</b>
Keyway width (mm)	<b>7.9</b>
Keyway width (in)	<b>0.31</b>
Keyway depth (mm)	<b>3.2</b>
Keyway depth (in)	<b>0.13</b>
A (mm)	<b>38.4</b>
A (in)	<b>1.51</b>
B (mm)	<b>22.2</b>
B (in)	<b>0.87</b>
D (mm)	<b>36.9</b>
D (in)	<b>1.45</b>
E (mm)	-
E (in)	-
F (mm)	<b>6.350 x 12.700</b>
F (in)	-
Weight (kg)	<b>0.07</b>
Weight (lbs)	<b>0.15</b>