

# PCMW 325401.5 E

## Dimensions

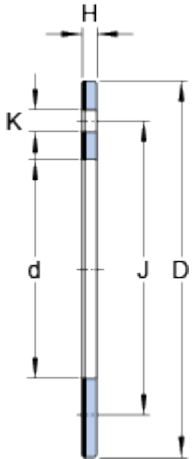

$d$	32	mm
$D$	54	mm
$H$	1.5	mm
$J$	43	mm
$K$	4.25	mm

## Abutment dimensions

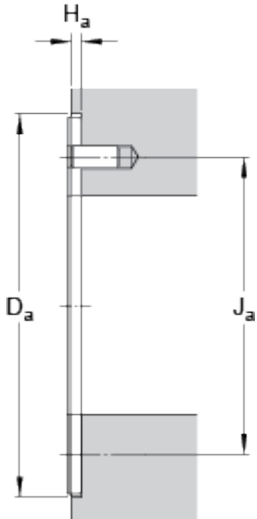

$D_a$	54	mm
$J_a$	43	mm
$H_a$	1	mm

## Calculation data

Basic dynamic load rating - radial direction	C	116	kN
Basic static load rating - radial direction	C	365	kN
Specific dynamic load factor	K	80	N/mm <sup>2</sup>
Specific static load factor	K	250	N/mm <sup>2</sup>
Factor depending on material and bearing type	$K_M$	300	
Permissible sliding velocity	$v$ max.	2	m/s
Permissible sliding velocity	$v$ min.	0	m/s
Coefficient of friction	$\mu$ max.	0.25	
Coefficient of friction	$\mu$ min.	0.03	

## Mass

Mass thrust washer	0.016	kg
--------------------	-------	----

