

# NU 1013 ML

## Dimensions

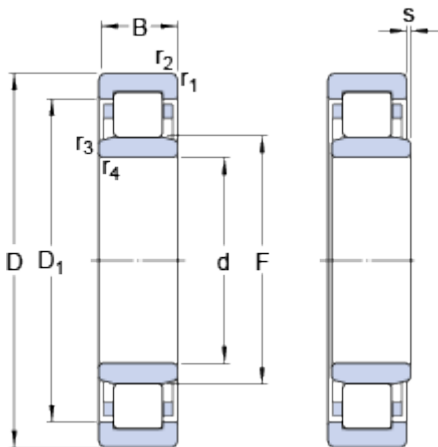

d	65	mm
D	100	mm
B	18	mm
D <sub>1</sub>	≈ 86.6	mm
F	74.5	mm
r <sub>1,2</sub>	min. 1.1	mm
r <sub>3,4</sub>	min. 1	mm
s	max. 2.9	mm

## Abutment dimensions

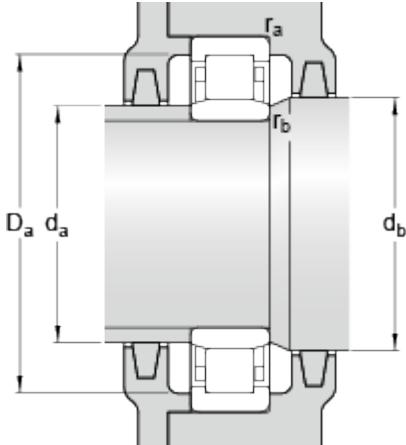

d <sub>a</sub>	min. 69.6	mm
d <sub>a</sub>	max. 72	mm
d <sub>b</sub>	min. 76	mm
D <sub>a</sub>	max. 94	mm
r <sub>a</sub>	max. 1	mm
r <sub>b</sub>	max. 1	mm

## Calculation data

Basic dynamic load rating	C	38	kN
Basic static load rating	C	46.5	kN
Fatigue load limit	P <sub>u</sub>	5.5	kN
Reference speed		7500	r/min
Limiting speed		12000	r/min
Calculation factor	k <sub>r</sub>	0.15	
Limiting value	e	0.2	
Axial load factor	Y	0.6	

## Mass

Mass bearing	0.51	kg
--------------	------	----