

NU 1009 ECP

Dimensions

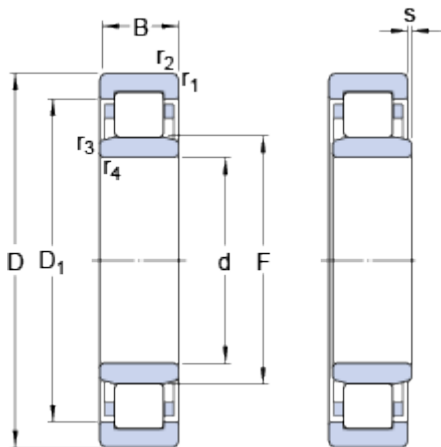

d		45	mm
D		75	mm
B		16	mm
D ₁	≈	65.3	mm
F		52.5	mm
r _{1,2}	min.	1	mm
r _{3,4}	min.	0.6	mm
s	max.	0.9	mm

Abutment dimensions

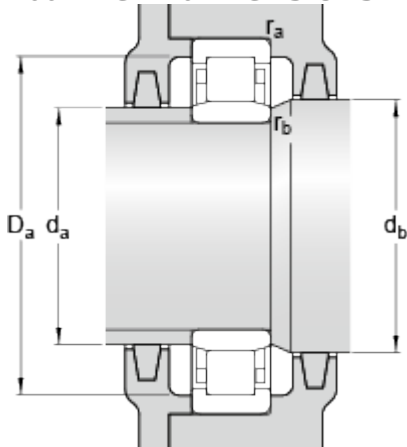

d _a	min.	48.4	mm
d _a	max.	51	mm
d _b	min.	54	mm
D _a	max.	69.8	mm
r _a	max.	1	mm
r _b	max.	0.6	mm

Calculation data

Basic dynamic load rating	C	44.6	kN
Basic static load rating	C	52	kN
Fatigue load limit	P _u	6.3	kN
Reference speed		11000	r/min
Limiting speed		11000	r/min
Calculation factor	k _r	0.1	
Limiting value	e	0.2	
Axial load factor	Y	0.6	

Mass

Mass bearing		0.25	kg
--------------	--	------	----