

NKX 30

Dimensions

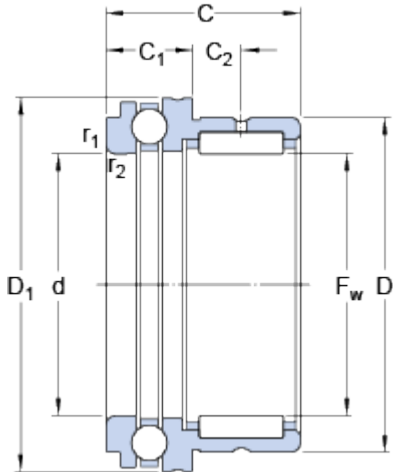

F_w	30	mm
D	42	mm
C	30	mm
C_1	11	mm
C_2	9.5	mm
d	30	mm
D_1	47.1	mm
$r_{1,2}$	min. 0.6	mm

Abutment dimensions

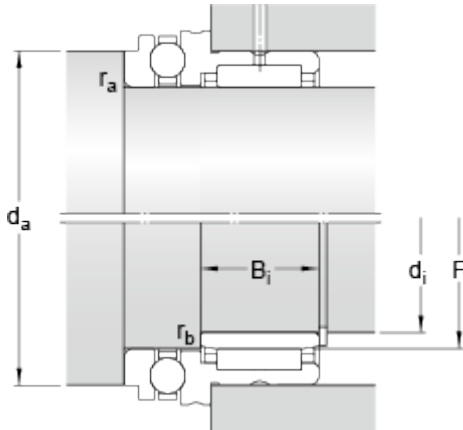

d_a	min. 42.7	mm
r_a	max. 0.6	mm
r_b	max. 0.3	mm
d_i	25	mm
F	30	mm
B_i	20	mm

Calculation data

Basic dynamic load rating, radial direction	C	22.9	kN
Basic static load rating, radial direction	C	38	kN
Basic dynamic load rating, axial direction	C	20.3	kN
Basic static load rating, axial direction	C	45.5	kN
Fatigue load limit, radial direction	P_u	4.8	kN
Fatigue load limit, axial direction	P_u	1.7	kN
Minimum axial load factor	A	0.01	
Reference speed		6000	r/min
Limiting speed		8500	r/min

Mass

Mass bearing	0.14	kg
--------------	------	----

Associated products

Inner ring	IR 25x30x20
------------	-------------

