

# NKX 20 Z

## Dimensions

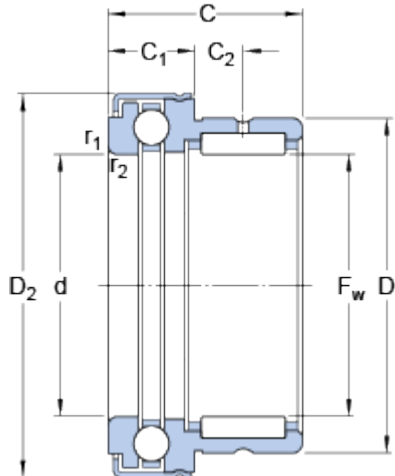

|                  |          |    |
|------------------|----------|----|
| F <sub>w</sub>   | 20       | mm |
| D                | 30       | mm |
| C                | 30       | mm |
| C <sub>1</sub>   | 10       | mm |
| C <sub>2</sub>   | 10.5     | mm |
| d                | 20       | mm |
| D <sub>2</sub>   | 36.2     | mm |
| r <sub>1,2</sub> | min. 0.3 | mm |

## Abutment dimensions

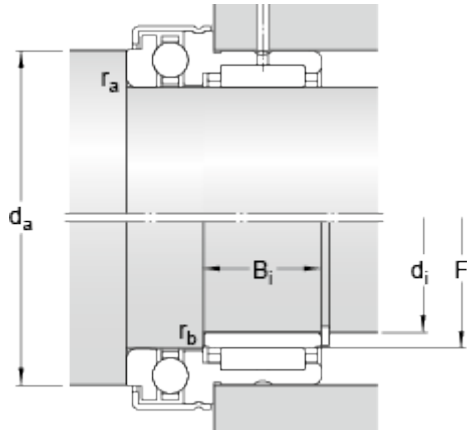

|                |           |    |
|----------------|-----------|----|
| d <sub>a</sub> | min. 30.7 | mm |
| r <sub>a</sub> | max. 0.3  | mm |
| r <sub>b</sub> | max. 0.3  | mm |
| d <sub>i</sub> | 17        | mm |
| F              | 20        | mm |
| B <sub>i</sub> | 20        | mm |

## Calculation data

|   |                |        |       |
|---|----------------|--------|-------|
| Basic dynamic load rating, radial direction | C              | 16.5   | kN    |
| Basic static load rating, radial direction  | C              | 25.5   | kN    |
| Basic dynamic load rating, axial direction  | C              | 14.3   | kN    |
| Basic static load rating, axial direction   | C              | 27     | kN    |
| Fatigue load limit, radial direction        | P <sub>u</sub> | 3.05   | kN    |
| Fatigue load limit, axial direction         | P <sub>u</sub> | 1      | kN    |
| Minimum axial load factor                   | A              | 0.0038 |       |
| Reference speed                             |                | 7500   | r/min |
| Limiting speed                              |                | 6000   | r/min |

## Mass

|              |      |    |
|--------------|------|----|
| Mass bearing | 0.09 | kg |
|--------------|------|----|

## Associated products

|            |             |
|------------|-------------|
| Inner ring | IR 17x20x20 |
|------------|-------------|

