

# NKIB 5910

## Dimensions

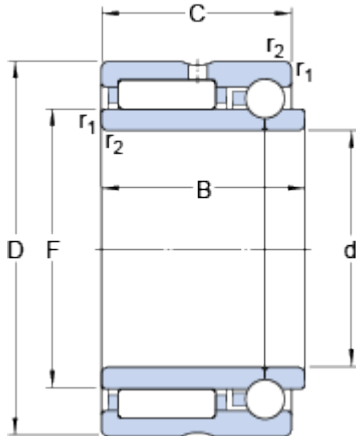

d	50	mm
D	72	mm
B	34	mm
C	30	mm
F	58	mm
r <sub>1,2</sub>	min. 0.6	mm

## Abutment dimensions

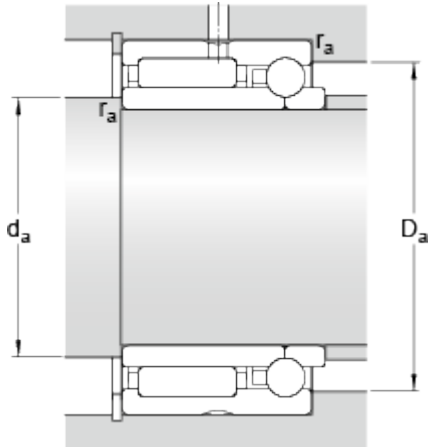

d <sub>a</sub>	min.	54	mm
D <sub>a</sub>	max.	68	mm
r <sub>a</sub>	max.	0.6	mm

## Calculation data

Basic dynamic load rating, radial direction	C	47.3	kN
Basic static load rating, radial direction	C	85	kN
Basic dynamic load rating, axial direction	C	7.74	kN
Basic static load rating, axial direction	C	13.7	kN
Fatigue load limit, radial direction	P <sub>u</sub>	10.6	kN
Fatigue load limit, axial direction	P <sub>u</sub>	0.579	kN
Reference speed		7000	r/min
Limiting speed		8000	r/min

## Mass

Mass bearing	0.39	kg
--------------	------	----