

NKIB 5908

Dimensions

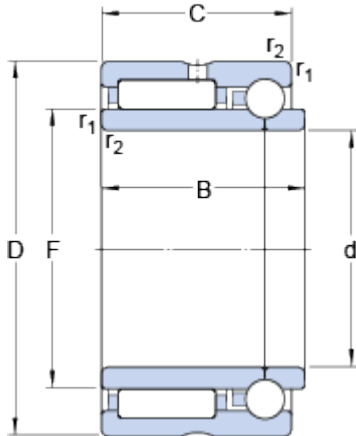

d	40	mm
D	62	mm
B	34	mm
C	30	mm
F	48	mm
r _{1,2}	min. 0.6	mm

Abutment dimensions

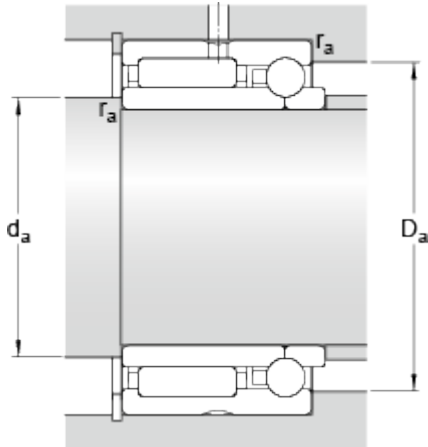

d _a	min. 44	mm
D _a	max. 58	mm
r _a	max. 0.6	mm

Calculation data

Basic dynamic load rating, radial direction	C	42.9	kN
Basic static load rating, radial direction	C	71	kN
Basic dynamic load rating, axial direction	C	7.17	kN
Basic static load rating, axial direction	C	10.9	kN
Fatigue load limit, radial direction	P _u	8.8	kN
Fatigue load limit, axial direction	P _u	0.467	kN
Reference speed		8000	r/min
Limiting speed		9500	r/min

Mass

Mass bearing	0.32	kg
--------------	------	----