

# NKIB 5907

## Dimensions

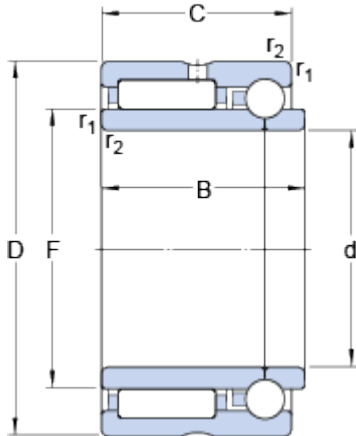

d	35	mm
D	55	mm
B	30	mm
C	27	mm
F	42	mm
r <sub>1,2</sub>	min. 0.6	mm

## Abutment dimensions

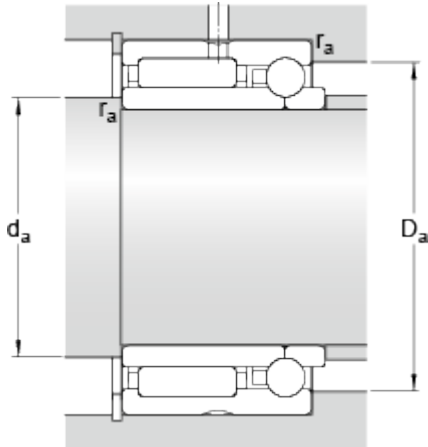

d <sub>a</sub>	min.	39	mm
D <sub>a</sub>	max.	51	mm
r <sub>a</sub>	max.	0.6	mm

## Calculation data

Basic dynamic load rating, radial direction	C	31.9	kN
Basic static load rating, radial direction	C	54	kN
Basic dynamic load rating, axial direction	C	5.83	kN
Basic static load rating, axial direction	C	8.42	kN
Fatigue load limit, radial direction	P <sub>u</sub>	6.7	kN
Fatigue load limit, axial direction	P <sub>u</sub>	0.355	kN
Reference speed		9500	r/min
Limiting speed		11000	r/min

## Mass

Mass bearing	0.25	kg
--------------	------	----