

# KRV 40 PPA

## Dimensions

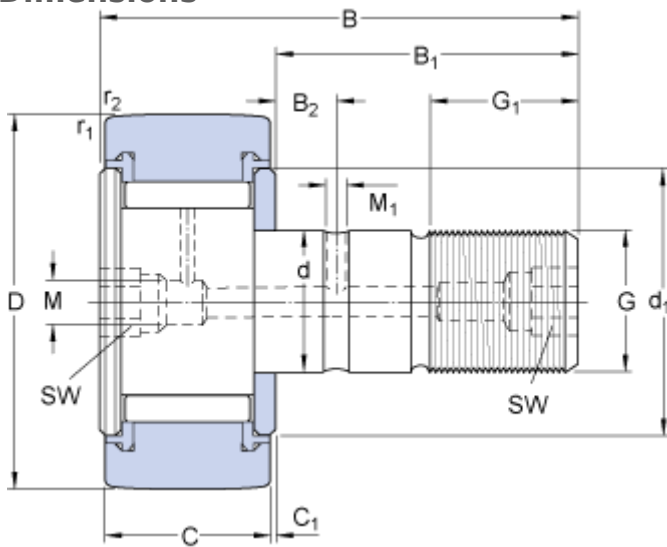

D	40	mm
d	18	mm
B	58	mm
C	20	mm
B <sub>1</sub>	36.5	mm
B <sub>2</sub>	8	mm
C <sub>1</sub>	0.8	mm
d <sub>1</sub>	31.5	mm
G	M 18x1.5	
G <sub>1</sub>	19	mm
M	6	mm
M <sub>1</sub>	3	mm
SW	8	mm
r <sub>1,2</sub>	min. 1	mm

## Calculation data

Basic dynamic load rating	C	14.2	kN
Basic static load rating	C	26.5	kN
Fatigue load limit	P <sub>u</sub>	3.1	kN
Maximum dynamic radial loads	F <sub>r</sub> max.	17	kN
Maximum static radial loads	F <sub>or</sub> max.	24.5	kN
Limiting speed		2200	r/min

## Mass

Mass cam follower	0.25	kg
-------------------	------	----

## Mounting information

Recommended tightening torque	87	N·m
-------------------------------	----	-----

## Included products

Grease fitting	NIP A2x7.5
Hexagonal nut	M 18x1.5

## Associated products

Lubrication adapter	AP 8
---------------------	------

