

KM 25

Dimensions

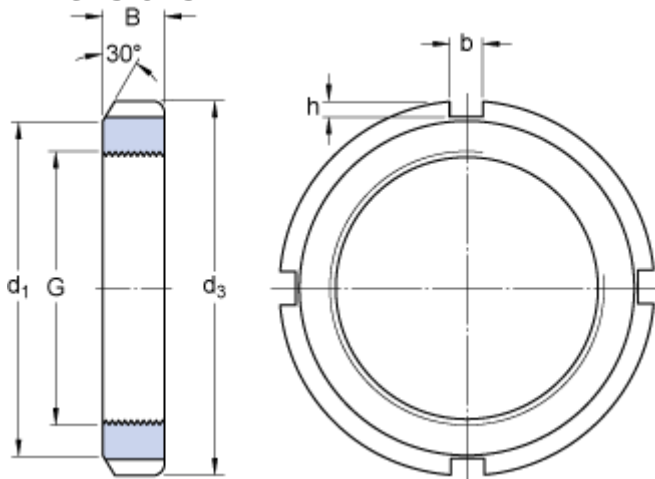

G	M 125x2	
d_3	160	mm
B	21	mm
d_1	148	mm
b	12	mm
h	5	mm

Calculation data

Axial static load carrying capacity 360 kN

Mass

Mass lock nut 1.1 kg

Mounting information

Associated spanner TMFN 23-30

Associated products

Lock washer / Locking clip [MB 25](#)