

# KM 19

## Dimensions

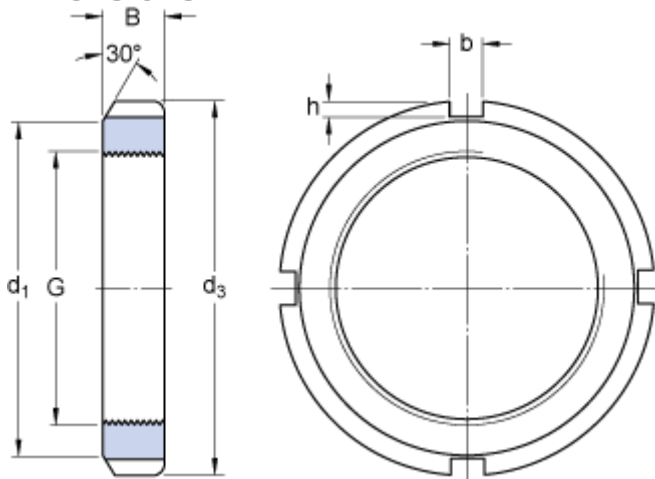

G	M 95x2	
$d_3$	125	mm
B	17	mm
$d_1$	113	mm
b	10	mm
h	4	mm

## Calculation data

Axial static load carrying capacity 236 kN

## Mass

Mass lock nut 0.55 kg

## Mounting information

Associated spanner HN 18-20

## Associated products

Lock washer / Locking clip [MB 19](#)