

KM 17

Dimensions

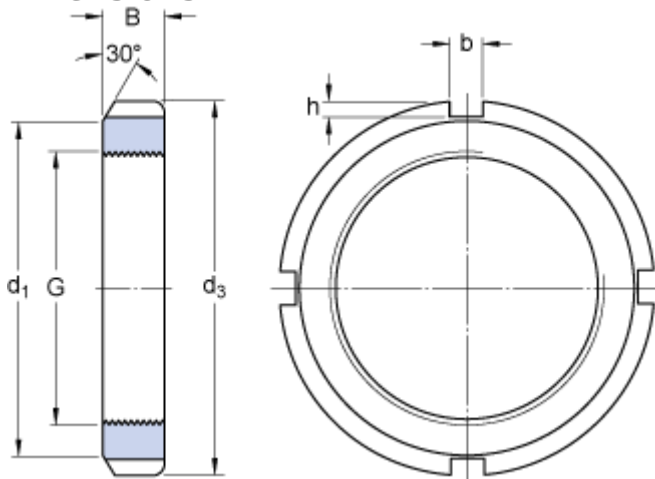

G	M 85x2	
d_3	110	mm
B	16	mm
d_1	102	mm
b	8	mm
h	3.5	mm

Calculation data

Axial static load carrying capacity 190 kN

Mass

Mass lock nut 0.41 kg

Mounting information

Associated spanner HN 17

Associated products

Lock washer / Locking clip [MB 17](#)