

# KM 15

## Dimensions

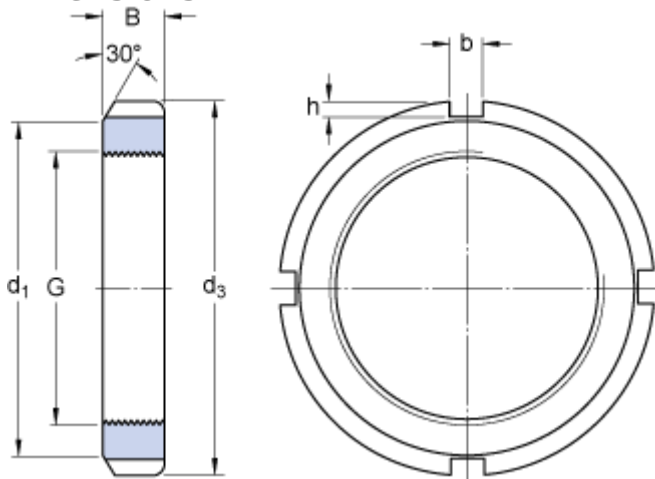

G	M 75x2	
$d_3$	98	mm
B	13	mm
$d_1$	90	mm
b	8	mm
h	3.5	mm

## Calculation data

Axial static load carrying capacity 134 kN

## Mass

Mass lock nut 0.27 kg

## Mounting information

Associated spanner HN 15

## Associated products

Lock washer / Locking clip [MB 15](#)