

KM 12

Dimensions

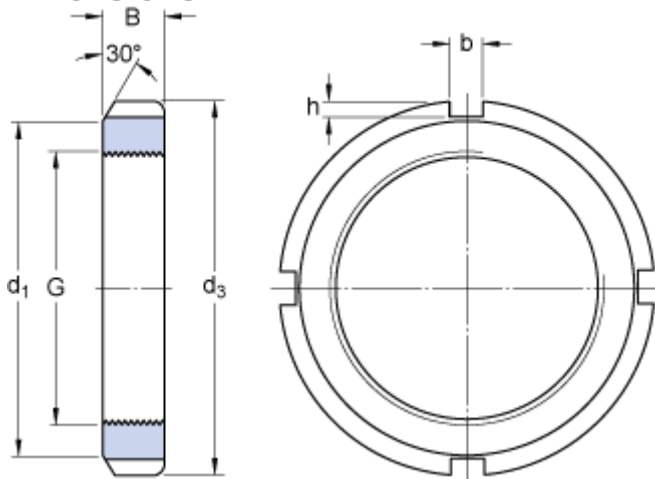

G	M 60x2	
d_3	80	mm
B	11	mm
d_1	73	mm
b	7	mm
h	3	mm

Calculation data

Axial static load carrying capacity 95 kN

Mass

Mass lock nut 0.16 kg

Mounting information

Associated spanner HN 12-13

Associated products

Lock washer / Locking clip [MB 12](#)